

# \$1,000,000 - 4730 Halehoola Pl, Honolulu

MLS® #202222299

**\$1,000,000**

0 Bedroom, 0.00 Bathroom,  
Single Family on 14 Acres

MAUNALANI HEIGHTS, Honolulu, HI

Imagine your custom designed home nestled on the slopes of Maunalani Heights. You will be mesmerized by postcard perfect views from this rare estate sized parcel overlooking Waikiki, the sparkling Pacific Ocean, Palolo Valley, Ko'olau Mountains and spectacular sunsets. Just 4.2 miles to beaches of Diamond Head's Gold Coast with a short commute to Hawaii's financial center, trendy Waialae Avenue, restaurants, boutique shops & major hospitals. Private cul-de-sac close to public transportation & Maunalani community Park with tennis court & recreation center. Street frontage parcel of 3,000 sq ft is zoned residential (R-10). Remaining acreage with preservation zoning (P-1) may allow construction of one residential structure. With a growing emphasis on sustainable living, this property presents an ideal platform for environmentally-conscious development. Harness the abundant natural resources and embrace eco-friendly building practices to create a net-zero paradise. Buyer to do independent due diligence. Bring your favorite architect, contractor or developer & visionary ideas.

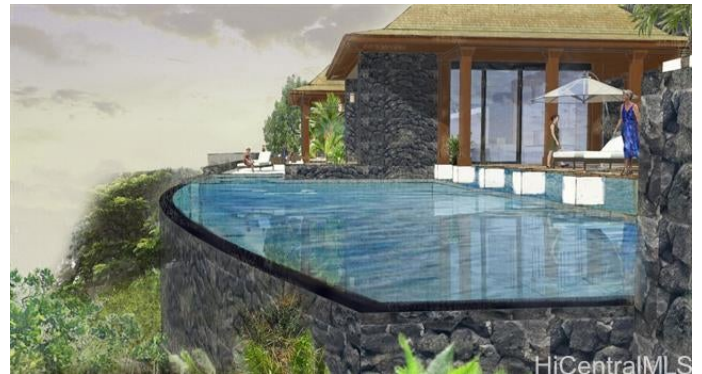

## Essential Information

|           |             |
|-----------|-------------|
| MLS® #    | 202222299   |
| Price     | \$1,000,000 |
| Bathrooms | 0.00        |

|          |                      |
|----------|----------------------|
| Acres    | 13.64                |
| Type     | Single Family        |
| Sub-Type | Single Family        |
| Style    | Detach Single Family |
| Status   | Active               |

## Community Information

|             |                   |
|-------------|-------------------|
| Address     | 4730 Halehoola Pl |
| Area        | DiamondHd         |
| Subdivision | MAUNALANI HEIGHTS |
| City        | Honolulu          |
| State       | HI                |
| Zip Code    | 96816             |

## Amenities

|           |   |
|-----------|---|
| Amenities | None  |
| Utilities | Gas, Public Water, Sewer Connection Req'd, Telephone, Underground Electricity |
| Parking   | Driveway  |
| View      | City, Coastline, Mountain, Ocean, Sunset                                      |
| Pool      | None  |

## Interior

|         |     |
|---------|-----|
| Stories | One |
|---------|-----|

## Exterior

|                 |                            |
|-----------------|----------------------------|
| Exterior        | Above Ground, Concrete     |
| Lot Description | Irregular, Rim Lot, Wooded |

## School Information

|            |         |
|------------|---------|
| Elementary | Waialae |
| Middle     | Kaimuki |
| High       | Kalani  |

## Additional Information

|                |                    |
|----------------|--------------------|
| Date Listed    | October 25th, 2022 |
| Days on Market | 567                |

## Listing Details

|                |                        |
|----------------|------------------------|
| Listing Office | Coldwell Banker Realty |
|----------------|------------------------|

Based on information from the Multiple Listing Service of the HiCentral MLS®, Ltd. active listings last updated on May 14th, 2024 at 12:03pm PDT. Information is deemed reliable but not guaranteed. Copyright: 2024 by the HiCentral MLS®, Ltd. Listing information is provided exclusively for consumers' personal, non-commercial use and may not be used for any purpose other than to identify prospective properties consumers may be interested in purchasing. Some of the active listings appearing on this site may be listed by other REALTORS®. If you are interested in those active listings, our company may represent you as the buyer's agent. If the active listing you are interested in is our company's active listing, you may speak to one of our agents regarding your options for representation.